

FORM NO 1.

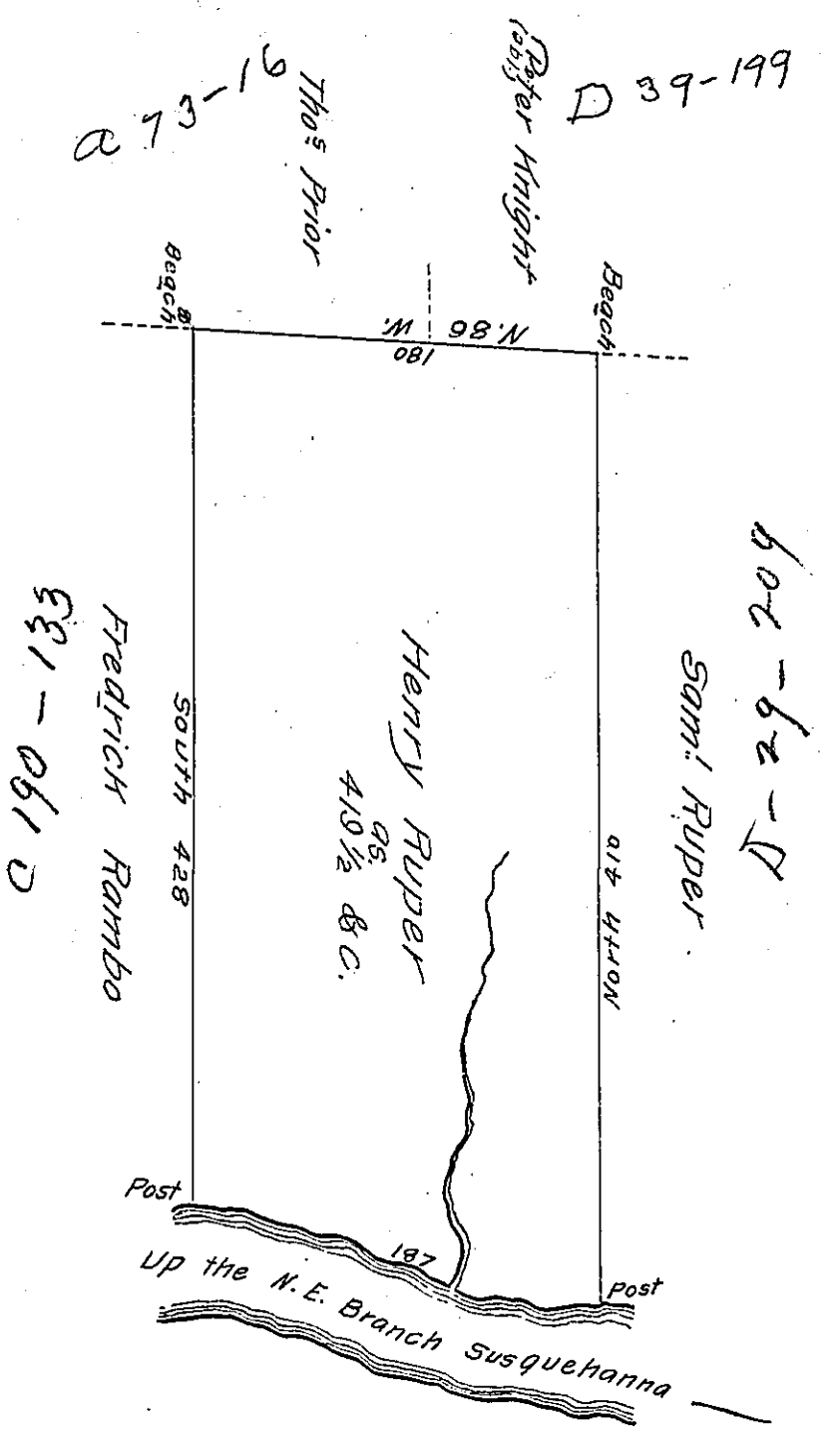

A Draught of a tract of Land called — Situate on the N.E. Branch of Susqu^a — in the Great Bend adjoining Land Surv^d for Fred^d Rambo & others in Northum^a County Containing four hundred & 19 acres 1/2 & allowance of six ¹/₂ Cent. for roads & c surv^d — Henry Ruper the 27th day of May 1785 in pursuance of a warrant dated the 4th day of April 1785.

To John Lukens Esqr. } by W^m Gray D.S.
 Surv^r. Genl. }

IN TESTIMONY that the above is a copy of the original remaining on file in the Department of Internal Affairs of Pennsylvania, made conformably to an Act of Assembly approved the 16th day of February, 1833, I have hereunto set my Hand and caused the Seal of said Department to be affixed at Harrisburg, this fourth day of February 1908.

Henry Houder
 Secretary of Internal Affairs.